

Submittal Data: 9RLF
Inverter Driven Heat Pump

9,000 BTU Wall Mount

Job Name: _____

Date: _____

Location: _____

Approval: _____

Engineer: _____

Construction: _____

Submitted to: _____

Unit #: _____

Submitted by: _____

Drawing #: _____

Reference: _____

General Features

- Wired or wireless remote control
- Apple catchin filter
- Ion deodorizing filter
- Auto louver: up/down
- Low ambient cooling
- Cold prevention
- Sleep timer
- 24-hour timer
- Dry mode
- Standard Warranty: 5 years parts, 7 years compressor. Applies to systems purchased before June 1st 2015*
- Extended Warranty: 10 years parts, 10 years compressor. Systems that have been installed on or after June 1st 2015 by licensed contractors and the online Product Registration has been submitted.**
- Elite Contractor Extended Warranty: 12 years parts, 12 years compressor. Systems that have been installed on or after June 1st 2015 by contractors who have met requirements and have been approved for elite contractor status plus, the online Product Registration has been submitted.***

Model Information

Condenser..... AOU9RLF
 Evaporator..... ASU9RLF

Electrical..... 208/230 V AC 1ph-60HZ
 Available Voltage Range..... 187 - 253 V +/- 10%
 Max Fuse Size..... 20 A
 Max Operating Current

Condenser..... 7.5 A
 Evaporator..... 0.4 A
 Input Power
 Cooling..... 0.65 kW
 Heating..... 0.89 kW
 Running Current
 Cooling..... 3.2 A
 Heating..... 4.2 A

Capacity

Nominal Cooling..... 9,000 Btu/h
 Min-Max Cooling..... 1,700 – 10,900 Btu/h
 Nominal Heating..... 12,000 Btu/h
 Min-Max Heating..... 1,700 – 15,000 Btu/h

Compressor

..... Rotary x1
 Motor Output..... 500 W
 Refrigerant..... R410a
 Charge..... 1 lbs. 14 oz.
 Oil..... RB68

Fan Motor

Type: DC (condenser)..... Propeller x1
 Type: DC (evaporator)..... Cross flow fan x1
 Motor Output (condenser)..... 23 W
 Motor Output (evaporator)..... 30 W

Heat Exchanger

Condenser
 (H x W x D) in. (mm)..... 19-27/32 x 25-9/32 x 1-7/16 (504x642x36.4)
 Fin Pitch..... 1.4 FPI
 Rows x Stages..... 2 x 24
 Pipe Type (Material)..... Grooved H-Pin (Copper)
 Type (Material)..... Corrugate (Aluminum)

Note: Specifications are based on the following conditions:
 Cooling: Indoor temperature of 80°F (26.7°C) DB/67°F (19.44°C) WB, and outdoor temperature of 95°F (35°C) DB/75°F (23.9°C) WB.
 Heating: Indoor temperature of 70°F (21.1°C) DB/59°F (15°C) WB, and outdoor temperature of 47°F (8.33°C) DB/43°F (6.11°C) WB.
 Pipe length: 24ft. 7in. (7.5m), Height difference: 0ft. (0m) (Outdoor unit – indoor unit)
 (*Standard warranty / **10 year warranty / ***12 year warranty)



Operation Temperature Range

Cooling..... 15°F - 115°F (-10°C - 46°C)
 Heating..... 5°F - 75°F (-15°C - 24°C)

Efficiency

SEER..... 23.0
 EER (cooling)..... 4.05 kW/kW
 COP (heating)..... 3.95 kW/kW
 HSPF (heating)..... 11.0 Btu/h/W

Enclosure

Material
 Evaporator..... Polystyrene
 Condenser..... Painted galvanized steel
 Color
 Condenser..... Beige (10 YR 7.5/1.0 NN)
 Evaporator..... White

Sound Pressure Level

Condenser (max)..... 48 dB(A)
 Evaporator (max)..... 43 dB(A)

Dimensions

H x W x D
 Condenser in. (mm)..... 21-11/32 x 22 x 11-11/32 in. (540x660x290)
 Evaporator in. (mm)..... 11-1/32 x 31-3/32 x 8 (263x840x375)

Connection Pipe

Liquid..... Ø1/4 in. (Ø6.35 mm)
 Gas..... Ø3/8 in. (Ø9.52 mm)
 Method (Liquid/Gas)..... Flare
 Max Length {(Pre-charge)}..... 66 ft. (20 m) {(49 ft.) (15 m)}
 Max Height Difference..... 49 ft. (15 m)

Weight

Condenser..... 60 lbs. (27 kg)
 Evaporator..... 18 lbs. (8 kg)

Accessories

UTY-RNNUM^{^1}..... Wired remote control
 UTY-XWZZ5..... Dry contact wire kit

Intertek®ETL Number

AOU9RLF..... 91986
 ASU9RLF..... 91986

^{^1} Requires interface kit # UTY-XCBXZ1 in order to connect these devices to them.

Fujitsu General America, Inc.
 353 Route 46 West
 Fairfield, NJ 07004
 Toll Free: 1-888-888-3424
 Fax: (973) 836-0447
www.fujitsu-general.com

Dimensions: 9RLFW

[Unit: in. (mm)]

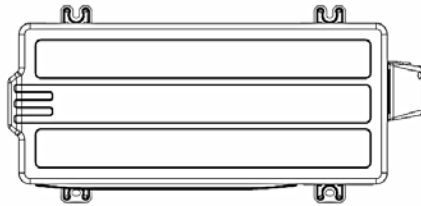
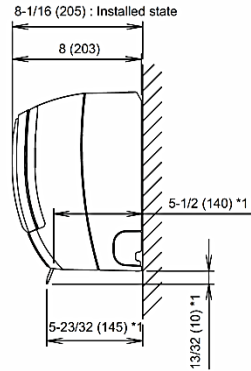
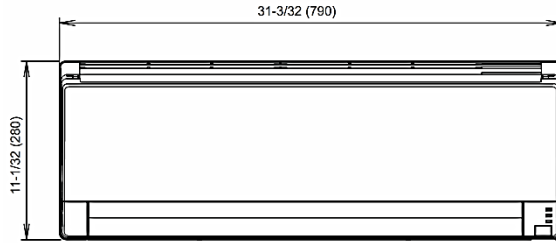

Top view

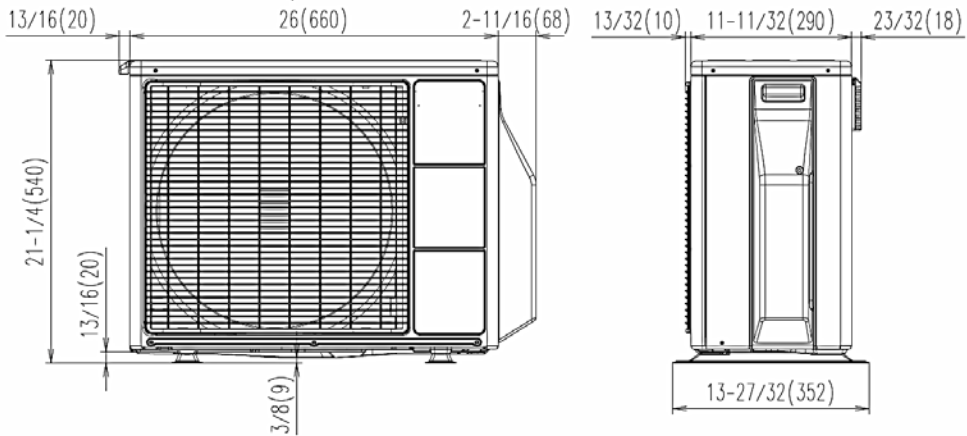

Front view

Side view

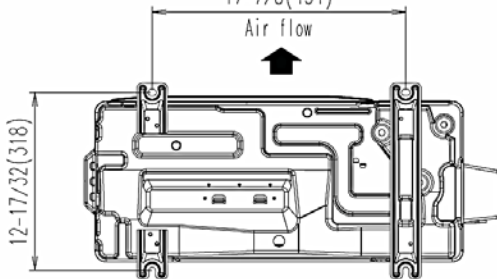

Bottom view

